

For detection of transparent labels
d.c. supply, Solid-state output

Fork design

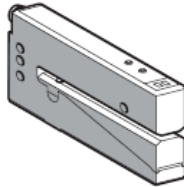

System		Thru-beam	
Type of transmission		Ultrasonic	
Nominal sensing distance (Sn)		3 mm (0.11")	
References			
4-wire, PNP and NPN	Light switching or dark switching programmable	XUV U06M3KCNM8	XUV U06M3KCNL2
Adjustment		By numerical potentiometer (+/- buttons) and red LED	
Protection of settings		By locking keypad	
Weight (kg)		0.130 (0.28 lbs)	
Characteristics			
Product certifications		CE IEC 60947-5-2, cULus	
Materials		Aluminium case	
Connection	Connector	M8 4-pin connector	-
	Cable	-	0.25 mm ² (24 AWG) PVC Cable
Detection performance	Minimum length of label	2 mm (0.07")	
	Minimum distance between 2 labels	2 mm (0.07")	
	Maximum flow rate	120 m/min	
	Detection accuracy	+/- 0.16 mm at 60 m/min +/- 0.30 mm at 120 m/min	
Power supply	Rated supply voltage	J 12...24 VDC with protection against reverse polarity	
	Voltage limits	J 10...30 VDC (including ripple)	
	Current consumption, no-load	40 mA	
	Residual voltage	At 100 mA < 2 VDC At 10 mA < 1 VDC	
Output	Type	NPN and PNP	
	Function	Light switching or dark switching, to be programmed	
	Maximum rated current	100 mA with overload and short-circuit protection	
	Maximum switching frequency	500 Hz	
	LED Indicators	Output state Yellow LED	
	Delay	On and Off: 500 ms	
Environment	Operating temperature	+ 5...+ 55 °C (+41...+131 °F)	
	Storage temperature	- 20 °C...+ 70 °C (-4...+158 °F)	
	Degree of protection	IP 65, NEMA 4X (indoor use only), 5, 12, 12K, 13	
Function table		Function	
		Thru-beam system	
		No label present in the beam (output inactive)	Label present in the beam (output active)
Output state (PNP or NPN) yellow LED (illuminated when sensor output is ON)	Light switching		
	Dark switching		

POB 1778 Greer, SC 29652
414 West Poinsett Street Greer, SC 29650
mtrask@bellsouth.net